

### 3 Phase Switchgear

- 125A TP&N distribution boards and devices
- Single pole and triple pole 10kA MCBs
- 6A to 40A RCBOs
- Enclosures are painted in epoxy powder in a light grey finish
- Additional devices and incomers are also available to order
- All boards are supplied as standard with hinged outer door and catch, and removable top and bottom gland plates
- Door locks are available to order

### Distribution Boards

**NEW**



- Surface mounting TP&N distribution boards
- 125A maximum incomer
- Busbars rated at 200A
- Full complement of neutral and earth terminals plus spares:  
Incoming maximum 70mm<sup>2</sup>  
Outgoing maximum 25mm<sup>2</sup>

Code	Description
<b>AVDB4</b>	4 way TP&N board
<b>AVDB6</b>	6 way TP&N board
<b>AVDB8</b>	8 way TP&N board
<b>AVDB12</b>	12 way TP&N board
<b>AVDB16</b>	16 way TP&N board

### Main Switch Incomer

**NEW**



- Main switch incomer
- 3 module

Code	Description
<b>AVDBMS125</b>	125A TP

### RCBOs

**NEW**



- Type C 10kA RCBOs
- Single module
- 30mA sensitivity
- Unswitched neutral

Code	Description
<b>AVDBR0630</b>	6A 30mA 10kA
<b>AVDBR1030</b>	10A 30mA 10kA
<b>AVDBR1630</b>	16A 30mA 10kA
<b>AVDBR2030</b>	20A 30mA 10kA
<b>AVDBR3230</b>	32A 30mA 10kA
<b>AVDBR4030</b>	40A 30mA 10kA

### MCBs

**NEW**

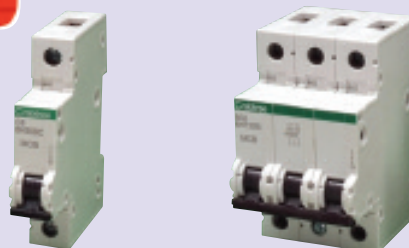

- Type C 10kA MCBs
- Single pole are single module and triple pole are three module
- Comply to BS EN 60898

Code	Description
<b>SINGLE POLE</b>	
<b>AVDBS06C</b>	6A
<b>AVDBS10C</b>	10A
<b>AVDBS16C</b>	16A
<b>AVDBS20C</b>	20A
<b>AVDBS32C</b>	32A
<b>AVDBS40C</b>	40A
<b>AVDBS50C</b>	50A
<b>AVDBS63C</b>	63A
<b>TRIPLE POLE</b>	
<b>AVDBT06C</b>	6A
<b>AVDBT10C</b>	10A
<b>AVDBT16C</b>	16A
<b>AVDBT20C</b>	20A
<b>AVDBT32C</b>	32A
<b>AVDBT40C</b>	40A
<b>AVDBT50C</b>	50A
<b>AVDBT63C</b>	63A



## Garage Units



AVGRG32

- Provides a power supply from the consumer unit in the main building to a garage, shed or other outbuilding giving earth leakage and individual circuit protection
- Approved to EN 60898 and EN 61008
- ABS enclosure with polycarbonate lid
- Supplied with earth and neutral busbars
- IP55 rated

Code	Description
<b>AVGRG16</b>	40A RCD with 6A and 16A MCBs
<b>AVGRG32</b>	40A RCD with 6A and 32A MCBs

## Shower Units



AVSU40



AVSU50

- Shower protection units
- AVSU40 is approved to EN 61009
- AVSU50 is approved to EN 60898 and EN 61008
- ABS enclosure with polycarbonate lid
- Supplied with earth and neutral busbars
- Rated at IP40

Code	Description
<b>AVSU40</b>	40A RCBO
<b>AVSU50</b>	50A MCB and 63A RCD

## DIN Rail

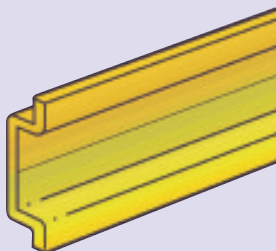

- 2 metre length
- Top hat type

Code	Description
<b>AVDR200</b>	DIN rail

## Rotary Isolator Switches



AVRS634

- Interlocking lid ensures removal in off position only
- 20mm knockouts up to 40A and 25mm knockouts on 63/80A
- IP65 rated

Code	Description
<b>AVRS204</b>	20A 4 pole
<b>AVRS254</b>	25A 4 pole
<b>AVRS324</b>	32A 4 pole
<b>AVRS404</b>	40A 4 pole
<b>AVRS634</b>	63A 4 pole
<b>AVRS804</b>	80A 4 pole

## Plug Top Fuses

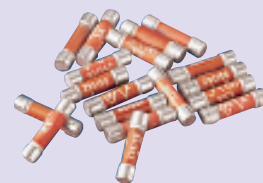

- BSI 362
- Packs of 10
- ASTA and BSI approved (1" x 1/4")

Code	Description
<b>AVPTF2</b>	2A (per 10)
<b>AVPTF3</b>	3A (per 10)
<b>AVPTF5</b>	5A (per 10)
<b>AVPTF7</b>	7A (per 10)
<b>AVPTF10</b>	10A (per 10)
<b>AVPTF13</b>	13A (per 10)

## Fuse Wire

Code	Description
<b>REEL</b>	
<b>AVFW30</b>	30A 35 swg
<b>CARD</b>	
<b>AVFWC</b>	5/15/30A